

Before assembly, please remove all parts from the carton, verifying that you have the correct quantities, and read all the instructions.

DIVIDER POST PARTS KIT (sold separately)

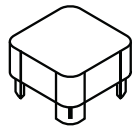

Top Cap x 1

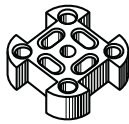

Mounting Plate x 1



1 1/4" Screw x 4

- a. Divider post x 1
- b. Cover strip x 3
- c. Threaded Rod x 1

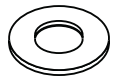

Washer x 1



Locknut x 1



1" Screw x 4

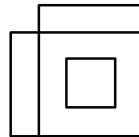

Template x 1

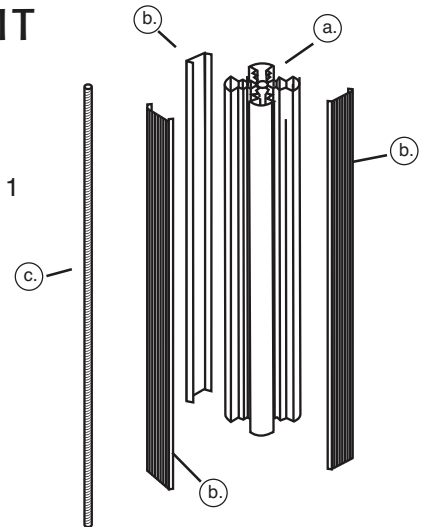

CLEAR PANEL PARTS KIT

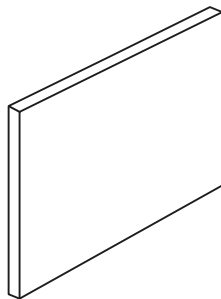

Regular Panel x 1



Filler Panel x 1



Spacer x 4



3/4" Screw x 8



Neoprene Strip x 2

STEP 1. ATTACH MOUNTING PLATE

- 1.1 Fold sides of template downward and position template tight against work surface corner.
- 1.2 Expose double sided tape and position mounting plate inside the template opening.
- 1.3 Remove the template and install the short 1" screw into one of the inside holes. Do not tighten.
DO NOT INSTALL ANY OTHER SCREWS

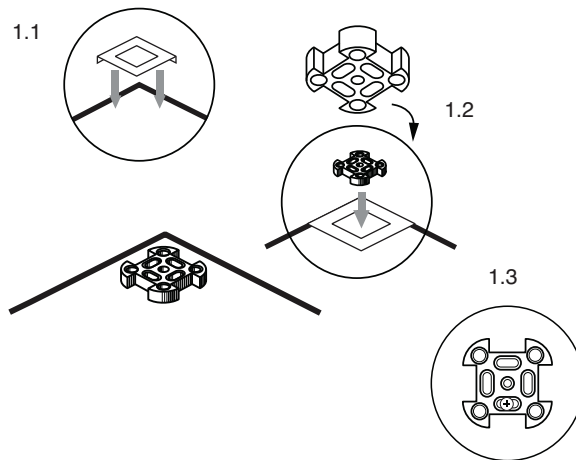

- 1.4 Install the mounting plate that is to be fixed at the other end of the work surface by following steps 1.1 to 1.3 above.

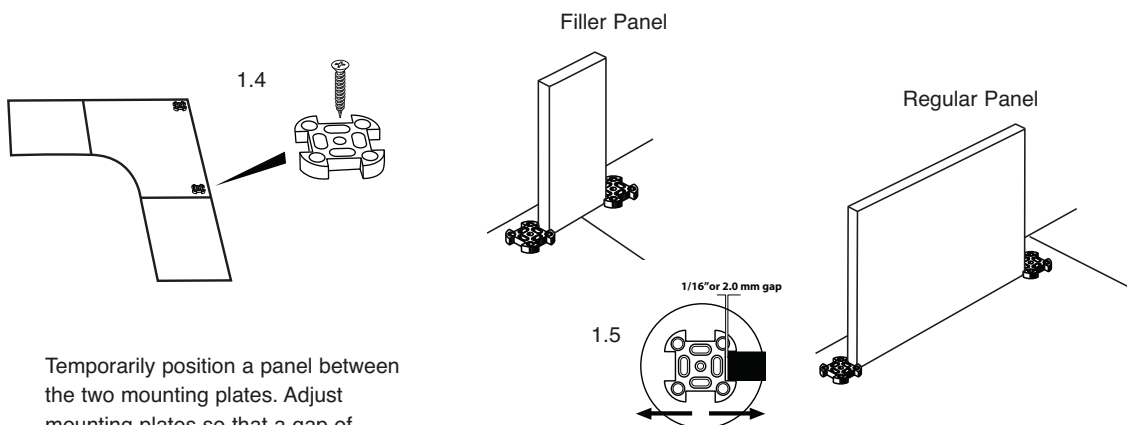

- 1.5 Temporarily position a panel between the two mounting plates. Adjust mounting plates so that a gap of approximately 1/16" or 2mm is between the panel and the plate.
- 1.6 Install all the remaining mounting plates that will be on your work surfaces following the above instructions. Remember when aligning the mounting plates use only the one short screw and do not tighten.

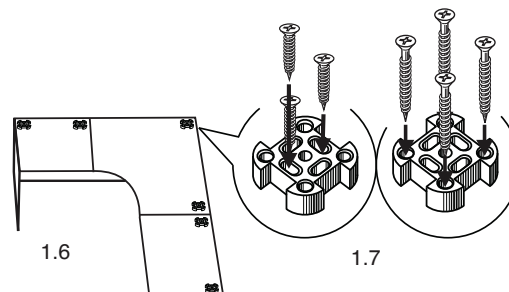

- 1.7 After all the mounting plates have been properly aligned, including having the panels temporarily positioned as per instruction 1.5, then install the remaining 3 - 1" screws in each mounting plate as shown, followed by the 4 - 1 1/4" in the four outside corners of the plate.

STEP 2. MOUNT DIVIDER POST

- 2.1 Place divider post over mounting plate.
- 2.2 Screw threaded rod through divider post and into mounting plate.
- 2.3 Place washer then nut on rod and finger tighten only.

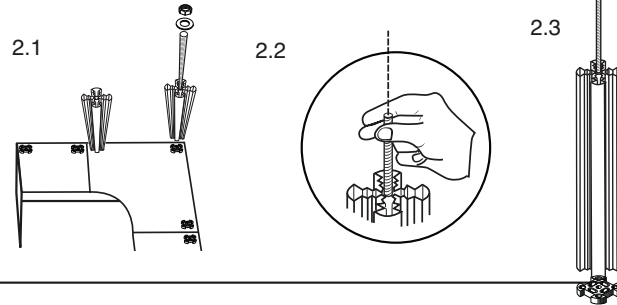

STEP 3. INSTALLING PANELS

- 3.1 Snap spacers into bottom of post channels.
- 3.2 Insert a 3/4" screw into threaded hole in each corner of the panel. Once all the way in, back out each screw 2 turns.
- 3.3 Slide panels into place, making sure that exposed screw head slides down appropriate channel on post.
- 3.4 In addition to the four screws, secure panel by inserting Neoprene strips between panel and post.
- 3.5 Ensure cover strips on the post are properly placed.
- 3.6 Tighten locking nut. Place caps on top of divider post.
- 3.7 If using 36" posts and 12" non clear panel, ensure spacer is installed on the bottom and follow Borders assembly instructions for stacking on panels.

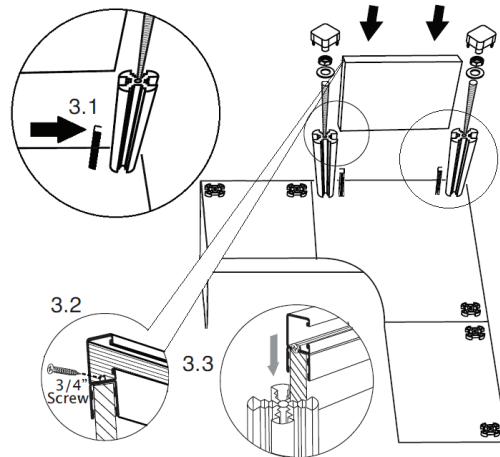

⚠ ATTENTION ⚠

Ensure all bolts and screws are tightened, check bolts and screws every 6 months.
If any parts are missing, broken, damaged or worn, stop use of product until repairs have been made using factory authorized parts.
Failure to follow these warnings may result in injury.